



**Insulated
Structures**

(1989)(Pty)Ltd.
Reg. Number 1971/05601/07

NARROW 800 SERIES UPRIGHT



Insulated Structures
12 Brunel Road Tulisa Park
Johannesburg South
services@cgis.co.za



Insulated Structures

(1989)(Pty)Ltd.

Reg. Number 1971/05601/07

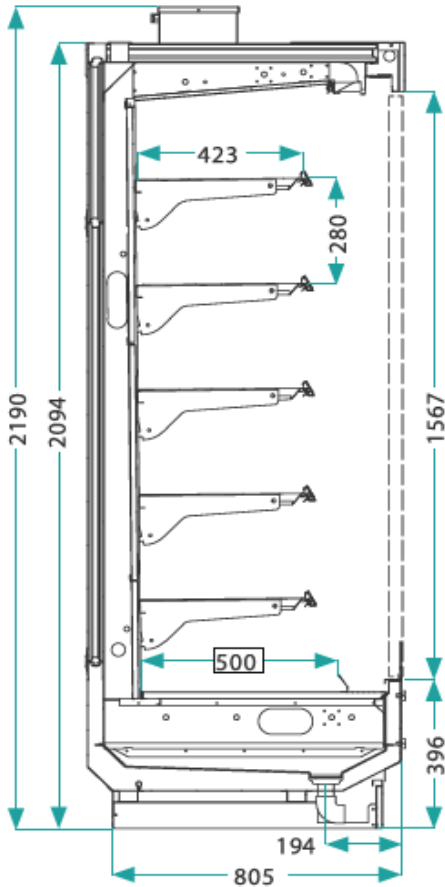

FLAT SHELVES

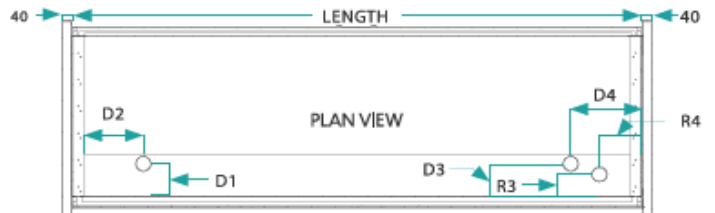
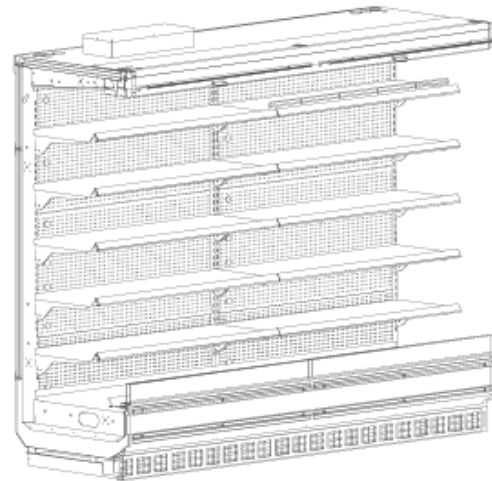

Standard Specifications

5 X Stainless Steel Shelves	2 x Probes (Air Off & Defrost)
LED Canopy Lights	Standard Coil
No Front Fences	Aluminium Ticket Rails
Shaded Pole Fan	Electronic Display
Valve (Brass Thermostatic)	



Insulated Structures

(1989)(Pty)Ltd.
Reg. Number 1971/05601/07

Optional Specifications

40mm Lofty Full Patch-Ends

40mm Lofty Patch-Ends w/Glass

Standard or Premium Airshield Doors

Manual Night Blinds

Shelf Fences

Electronic Fans

ECM Fans

Physical Properties			Drain and Refrigeration Points							
Size	Length (m)	TDA (m ²)	D1	D2	D3	D4	R1-top Exit	R2-Top Exit	R3-Btm Exit	R4-Btm Exit
4ft	1.220	1.98	200mm	600mm	-	-	100mm	90mm	150mm	180mm
6ft	1.830	3.00	200mm	300mm	200mm	300mm	100mm	90mm	150mm	180mm
8ft	2.440	3.96	200mm	300mm	200mm	300mm	100mm	90mm	150mm	180mm
12ft	3.660	5.95	200mm	300mm	200mm	300mm	100mm	90mm	150mm	180mm
Refrigeration Requirements			Electrical Specifications							
Product	Refrigeration	Evaporator Temp	Evaporator Fans Fan Motors + Motors		Heaters Anti-Sweat		Heaters Defrost	Lighting Canopy (LED)	Lighting Shelf (LED)	
Dairy	390W/ft	-6°C								
Specifications subject to change without notice. Designed for optimal performance in store environments where temperature and humidity do not exceed 25°C & 60%RH			2xø200-28°/36W (SPM) or 24W (ECM)		1 x 7W/m x 2.0m		1 x 800W	1 x 4ft=25W	6x4ft=72 W	
			3xø200-28°/36W (SPM) or 24W (ECM)		1 x 7W/m x 3.0m		1 x 1200 W	2 x 3ft=36W	12x3ft=120W	
			4xø200-28°/36W (SPM) or 24W (ECM)		1 x 7W/m x 4.88m		1 x 1600 W	2 x 4ft=50W	12x4ft=144 W	
			6xø200-28°/36W (SPM) or 24W (ECM)		1 x 7W/m x 7.3m		1 x 2400 W	3 x 4ft=75W	18x4ft=216W	